

# Fact Sheet

## LabelSecure

**BIZERBA**

*Visual label inspection: LabelSecure offers you a unique inspection performance for different products. The Vision inspection system checks labels for complete and correct information and intactness. As needed, LabelSecure is available for 100% control or for sampling.*



**More information**  
High performance with a wide range of solutions and options.

| Specifications                | Facts   | Details   |
|-------------------------------|---|---|
| <b>Functions</b>              | <p>Checking of presence, position and orientation of labels</p> <p>Reads information such as characters and codes on any side of the package</p> <ul style="list-style-type: none"> <li>– top</li> <li>– bottom</li> <li>– side</li> </ul> <p>Checks matching of labels</p> | <p>Independent of printing technology (ink-jet, thermal transfer, laser)</p> <p>Checks lateral label: presence and reading of label number</p>  |
| <b>Integration</b>            | <p>All these functions are efficiently fulfilled by one compact machine for an easy end-of-line integration.</p> <p>Before case packing, the stand-alone inspection machine detects defective packs and is able to reject them.</p>   | <p>basic, pro</p>   |
| <b>Versions</b>               | <p>basic</p> <p>pro</p>   | <p>Automated labeling check (top and/or bottom)</p> <p>Advanced automated labeling check (any side)</p>   |
| <b>Camera system</b>          | <p>One to four sensor(s)</p> <p>Protected against ambient light and manipulations</p>   | <p>Sensor consists of camera, lighting, and accessories.</p> <p>The quantity depends on the number of sides to be checked.</p> <p>pro: The image recording field adjusts to the size of the products to be inspected. Life of LED lighting is more than 5 years.</p> <p>pro: No external influences on the inspection results</p> |
| <b>Dimensions (L x W x H)</b> | <p>1,278 mm x 1,200 mm x 1,800 - 2,200 mm</p> <p>910 -1,380 mm x 1,016 mm x 1,645 - 1,965 mm</p>  | <p>basic: The highest point of the system at maximum extension of the camera head upwards is: 2,200 mm</p> <p>pro: Device dimensions without rejection unit</p> <p>Width is 1,136 mm with cooling device</p>  |
| <b>Housing</b>                | <p>Design according to hygiene requirements</p>   | <p>pro:</p> <ul style="list-style-type: none"> <li>– EHEDG certified components</li> <li>– Inclined surfaces for drainage of washing water</li> </ul>   |
| <b>IP rating</b>              | <p>IP20</p> <p>IP54</p> <p>IP65</p>   | <p>basic: Camera housing</p> <p>basic: Control cabinet</p> <p>pro: All optical inspection components are integrated in a tightly sealed stainless steel housing</p>   |
| <b>Max. conveying speed</b>   | <p>60 m/min</p>   | <p>basic, pro</p>   |

|                                    |   |   |
|------------------------------------|---|---|
| <b>Processing system</b>           | Industrial PC   | Operating system: Windows IoT Standard 10<br>Processor Intel® Core™ i7<br>Real time image processing card   |
| <b>Interfaces</b>                  | USB<br>ETHERNET   | Connection to customer network via Ethernet (TCP/IP possible)   |
| <b>Mains voltage</b>               | 230 VAC; 50 Hz / 110 VAC, 60 Hz (incl. transformer) + single phase + ground uninterruptible power supply (UPS) system for computing and display units | Open to other local voltage with a transformer  |
| <b>Ambient temperature</b>         | 1 °C to 35 °C   | With cooling device as from 15 °C   |
| <b>Humidity</b>                    | Max. 85%, non-condensing  |   |
| <b>Maintenance</b>                 | Tool-free dismantling of conveyor belts in less than one minute   | pro   |
| <b>Optical signaling device</b>    | Signal lamp   | Visual alarm for detection of non-conforming package  |
| <b>Conveying direction</b>         | from left to right<br>from right to left  |   |
| <b>By-pass mode</b>                | Switch activated with a key   | pro: Allows uninterrupted production even in case of an operating system failure  |
| <b>Options</b>                     | <b>Facts</b>  | <b>Details</b>  |
| <b>Checks</b>                      | Checking of product presence in a package<br><br>Appearance and arrangement of the products in the packaging  | Other inspections based on feasibility upon request   |
| <b>Production control</b>          | Communication interface to the process  | Data transfer within the factory concerning:<br>– System performance (monitoring of the device cycle, process data etc.)<br>– Production monitoring (history of batch changes, test statistics, archiving of batch changes) |
| <b>Rejection system</b>            | Upon request:<br>– Pusher<br>– Air-jet nozzle<br>Pusher   | basic<br>Compressed air supply: 6 bar<br><br>pro  |
| <b>IP rating</b>                   | IP66 upgrade  | pro<br>– Buttons<br>– Emergency stop switch<br>– Display  |
| <b>Special current transformer</b> | 115 V AC  | USA   |

## Info graphics

## Symbols

## Dimensional drawings

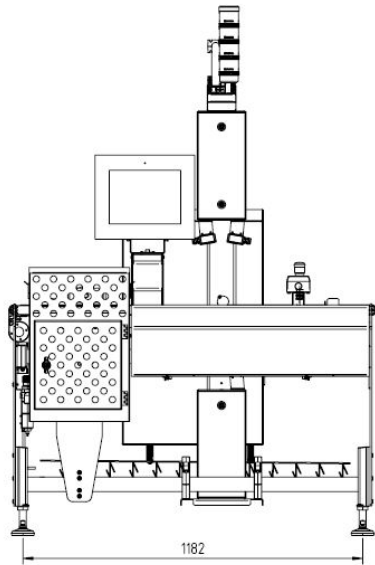

basic

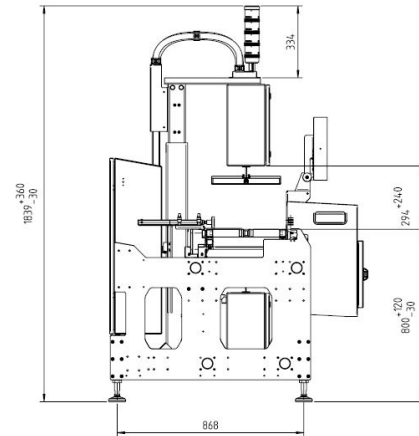

basic

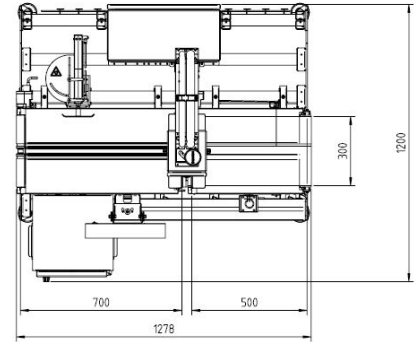

basic

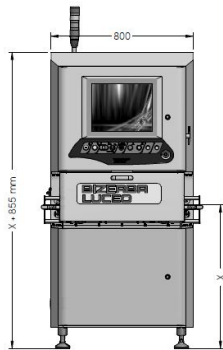

pro

Height conveyor 00:  
From 785 to 885 mm (STANDARD)  
From 885 to 1115 mm (OPTIONAL)

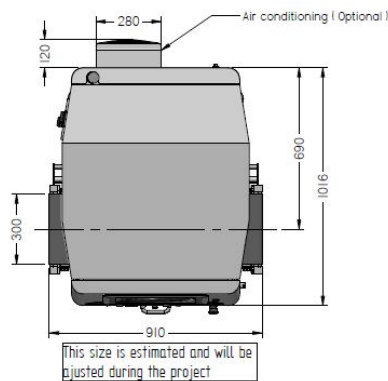

pro

This size is estimated and will be adjusted during the project

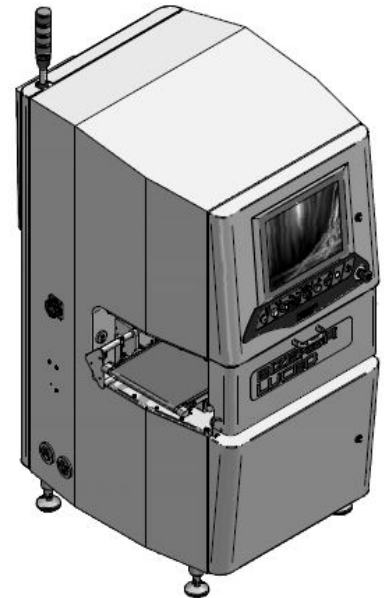

pro

**Bizerba SE & Co. KG**  
Wilhelm-Kraut-Straße 65  
72336 Balingen

T +49 7433 12-0  
fax: +49 7433 12-2696  
marketing@bizerba.com

[www.bizerba.com](http://www.bizerba.com)